

CONNECTORS

A6E201700006E02

Data link connector

- Insert the probe into the terminal when connecting a jumper wire to the data link connector.

Caution

- Inserting a jumper wire probe into the data link connector terminal may damage the terminal.

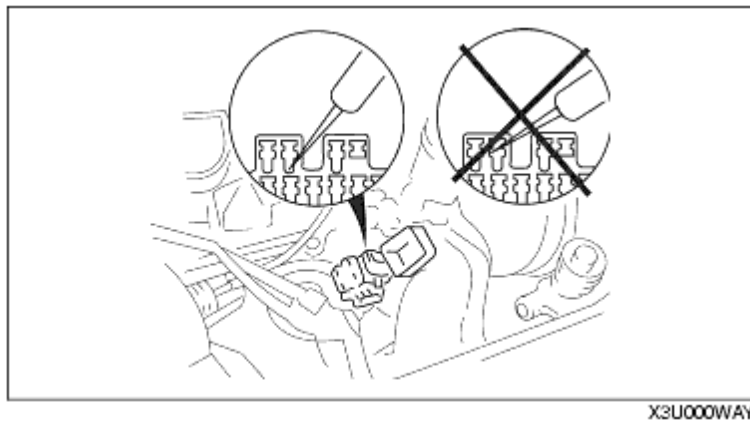

Disconnecting connectors

- When disconnecting connector, grasp the connectors, not the wires.

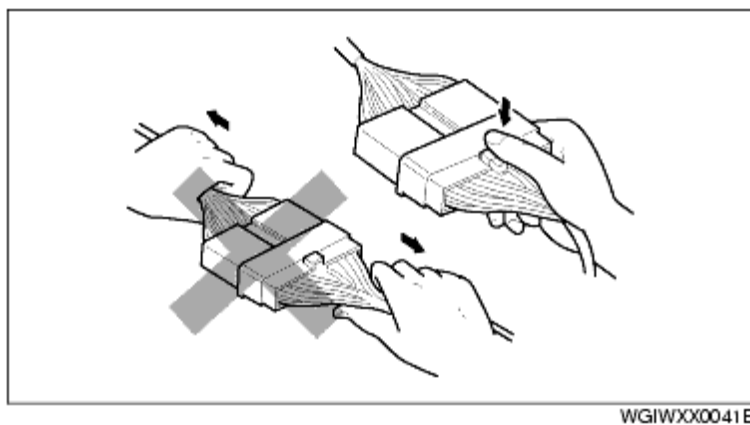

- Connectors can be disconnected by pressing or pulling the lock lever as shown.

Locking connector

- When locking connectors, listen for a click indicating they are securely locked.

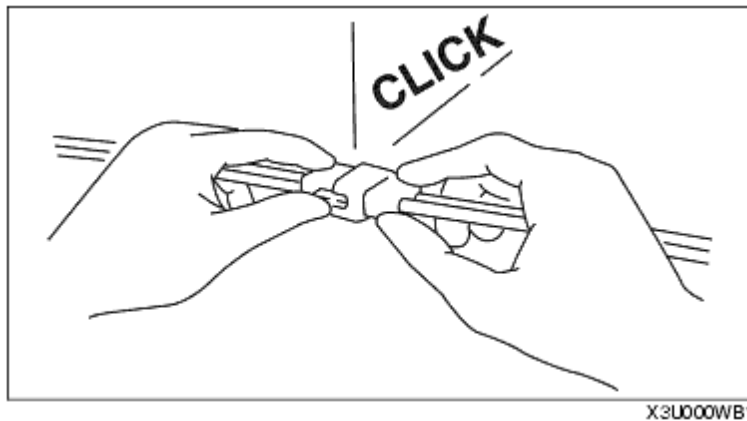

Inspection

- When a tester is used to inspect for continuity or measuring voltage, insert the tester probe from the wiring harness side.

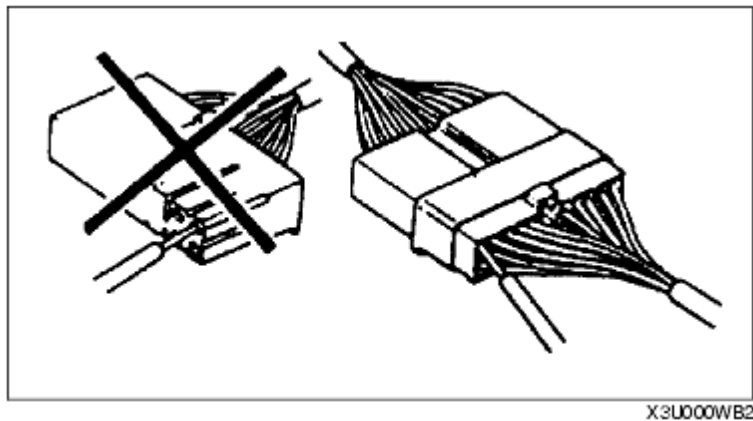

- Inspect the terminals of waterproof connectors from the connector side since they cannot be accessed from the wiring harness side.

Caution

- To prevent damage to the terminal, wrap a thin wire around the tester probe before inserting into terminal.

Terminals

Inspection

- Pull lightly on individual wires to verify that they are secured in the terminal.

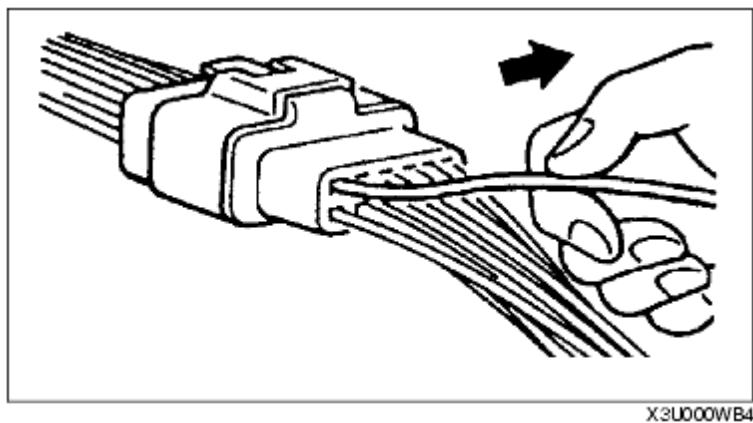

Wiring Harness

Wiring color codes

- Two-color wires are indicated by a two-color code symbol.
- The first letter indicates the base color of the wire and the second the color of the stripe.

CODE	COLOR	CODE	COLOR
B	Black	O	Orange
BR	Brown	P	Pink
G	Green	R	Red
GY	Gray	V	Violet
L	Blue	W	White
LB	Light Blue	Y	Yellow
LG	Light Green		

